

# 1/16TH SCALE 4WD ELECTRIC POWER RACE TRUCK

## INSTRUCTION MANUAL



### RACE TRUCK 4x4



# 14+

## YEARS

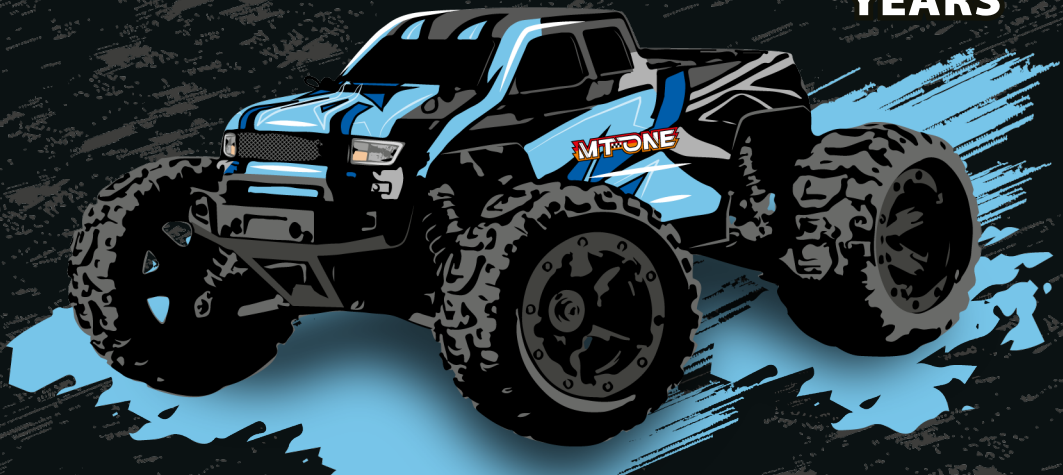

LENGTH	WIDTH	HEIGHT	WHEELBASE	WHEEL DIA.	WHEEL WIDTH	MOTOR	GEAR RATIO
270mm	215mm	130mm	175mm	78mm	41mm	RC 390	1:10.71

This data is subject to change without prior notification.

### BATTERY SAFETY INFORMATION

Disconnect and take out the battery pack from the vehicle when not in use. This will prevent damage from a leaking rechargeable battery pack. To prolong battery life, do not enable the vehicle to be used to a standstill resulting in the battery being completely drained. Fully charge the battery pack before each use. Do not leave battery pack uncharged for a long period of time. Store the battery pack in a dry, clean and cool condition.

- This product is not a toy. It is not intended for operators under 14 years of age, unless closely supervised by adults.
- This manual is subject to change without prior notice. The image may vary from the actual product.

## **Caution**

- 1) Please read and understand the manual before using, assembling, and/or disassembling.
- 2) This product is not a toy, it is a high powered RC model, which is not intended for operators under 14 years of age.
- 3) Children less than 14 years old must not operate this product unless they are closely supervised by an adult.
- 4) Fully charge the battery pack before use. Be sure to disconnect and remove the batteries from both the transmitter and the car when not in use.
- 5) Do not attempt to run the product while low on battery power. Fully charge the battery pack before use. Stop driving immediately when slow running speed is observed. Failure to do such can over drain the pack and cause damage.

## **General Safety Information:**

1. This manual is subject to change without prior notification.
2. This product is NOT a toy, and not intended for users under 14 years of age, unless closely supervised by an adult.
3. The specifications and images in the manual may vary from the actual product.
4. Operate this vehicle with due care and be always a good driver which is attentive to others.
5. Under no circumstances SHOULD the user operate the vehicle in crowds of people. Serious injury could result.
6. Never operate the vehicle on public streets or in public areas. This could cause traffic accidents, personal injury, and/or property damage. This vehicle is ONLY be driven on the open track which is for RC cars.
7. Do NOT use this vehicle to chase pets or other animals.
8. The receiver, steering servo and other electronics installed in this vehicle are merely splash water-resistant. Do not immerse this vehicle into water.
9. Regularly checking on the transmitter (radio controller) power is very important. Remove the batteries from the transmitter (radio controller) when not in use. Replace with fresh batteries if necessary. NEVER run this vehicle with low power from the transmitter.
10. When this vehicle becomes stuck, do NOT force on throttle. Failure to do so could cause abrupt damage to the motor and/or the ESC (Electronic Speed Controller). Check and clean the obstacles before running again.
11. Before running this vehicle check if the battery, wiring, and plugs are loose.
12. Be careful not to touch any moving parts when servicing or operating this vehicle.
13. To prevent excessive RPM from damaging the motor, and/or the drive-train components, we suggest reducing the throttle while performing in the air during jumps.
14. Never attempt to re-assemble motor, ESC, and receiver as these have been precisely calibrated at factory.
15. Always apply the factory optional/tooling parts to this vehicle.
16. To upgrade this vehicle requires the user to upgrade the entire radio/driving system (such as motor, ESC, receiver and so forth.) They should be strictly matched with factory components.
17. To run this vehicle, turn on the transmitter (radio controller) first and then the receiver.
18. To stop running this vehicle, turn off the receiver first, and then the transmitter.
19. Straighten the receiver antenna (if it comes with this vehicle) for best receiving performance. Never cut the receiver antenna, otherwise it could lose control of the vehicle.

# Practice Required:

Beginners should start slowly. Keep practicing until you feel comfortable with steering, throttle, and brakes. Once you feel comfortable driving the vehicle try a different terrain and speed until you have mastered the basics.

Once you have learned the basics, try different patterns and tracks to improve your skills.

Add a friend for a race or try to beat your best times!

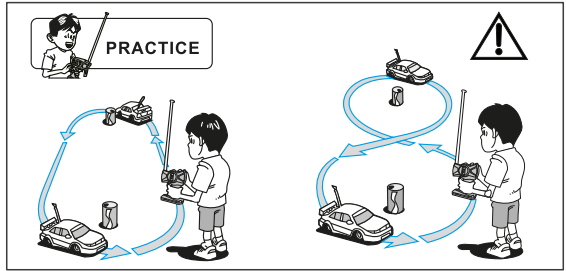

## 2.4GHz Transmitter Introduction:



- 1) Steering Wheel
- 2) Trigger
- 3) Steering Trim
- 4) Speed Selection
- 5) Steering Direction Reverse Switch
- 6) Power Indicator
- 7) Power ON/OFF
- 8) AUX. Button  
(This button is disabled for this car)

### Brushed ESC/Receiver:

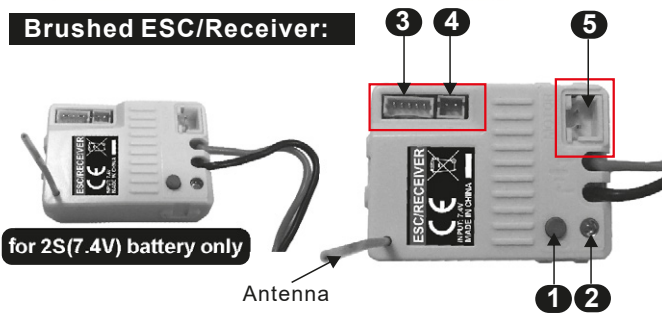

- 1) Power Switch: Press and hold for 2-3 seconds to switch on or off.
- 2) Power Indicator
- 3) Servo Slot (5-pin)  
(for 5-wire Servo)
- 4) Aux. Slot (for LED light if it contains LED)
- 5) Motor Plug Slot

**Always straighten the antenna for the best performance.**

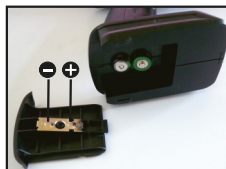

Slide and remove the battery cover from the transmitter, install two AA size batteries (1.5V, each), and replace the battery cover. Do not reverse the polarities when installing. Always use batteries of same brand and remove batteries when not in use. Make sure battery power is sufficient before use.

**Please replace the batteries for the transmitter if the transmitter LED blinks slowly.**

# Starting Driving:

## 1) Switch on the Transmitter:

Slide the Power Switch to "ON" position. Make sure the transmitter has enough battery power. Please replace with the new batteries for transmitter if the LED on transmitter blinks slowly. **Do NOT move the trigger and the steering wheel while the transmitter is waiting for binding.**



## 2) Switch on the ESC/Receiver:

Press and hold the Power Switch on ESC/Receiver for 2-3 seconds to turn on the car. It will take a few seconds before LEDs (on Transmitter and the ESC/Receiver) stop blinking and become solid on, which indicates that the car is bound with the transmitter. Binding operation may fail with low battery power. Please stop and charge the battery pack once the car jerks, cogs, or moves slowly. Under the circumstance of flat battery power, the car may have steering but not throttle. In case the car runs harshly or noisily, stop to check if there is something clogged in the drive train.



Press and hold for 2-3 seconds to switch on

## 3) Checking the steering performance by turning the steering wheel:

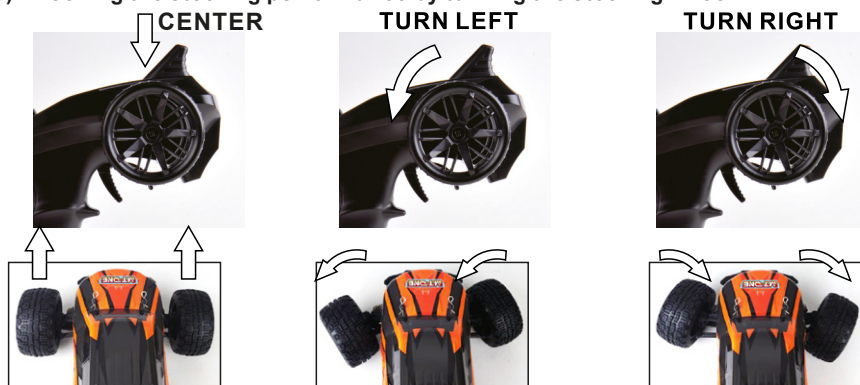

A) With the steering wheel centered, the vehicle runs in a straight line.

Slight adjustment by flipping the steering wheel is occasionally needed. It largely depends on the terrains that you drive.

B) Turn the steering wheel to the left, and the car turns left.

C) Turn the steering wheel to the right, and the car turns right.

## 4) Throttle Control:



Pull the trigger to accelerate, release it to slow the speed, and push to brake. Pull it to the Center Position and push again to go reverse.

### 5) Steering Trim Knob:



STEERING TRIM



It is used to set the steering neutral point on front wheels. If the front wheels on the vehicle veer in one direction while the steering wheel is centered, turn this knob in the opposite direction until the vehicle drives straight.

### 6) Speed Switch Knob:



SPEED SWITCH



The Speed Switch is actually the throttle limiter. Turning down the knob all the way will reduce the maximum speed down to 40% of maximum speed. Turning up the knob will increase max speed up to 100%. It is advisable to operate the vehicle on the slower setting until you have had enough practice before operating at higher speeds.

### 7) Steering Direction Reverse Switch:



STEERING REVERSE

If the vehicle turns right when you steer left, flip "Steering Reverse" switch.  
If the vehicle turns left when you steer right, flip "Steering Reverse" switch.

## Stopping Driving:

1) Switch off the ESC/Receiver:  
Press and hold the Power Switch for 2-3 seconds until LED on ESC/Receiver goes off.

2) Switch off the Transmitter:  
Slide Power Switch to "OFF" position

3) Disconnect and remove the battery pack from the car when not in use.  
Fully charge the battery pack before storing it.

4) Make sure there are no damage parts before storing it.



Press and hold for 2-3 seconds to switch off



# Charging The Battery Pack:

Use ONLY the specified charger (provided in the box) to charge the battery pack.

**Note: The balance USB charger is provided in the box.**

## ! WARNING!

- Do not charge the battery pack unattended.
- Do not use damaged and/or leaky batteries or a damaged charger.
- Children are not allowed to charge the battery without being closely supervised by adults.

## Precautions:

- Be sure to always disconnect the battery pack and remove it from the vehicle when not in use.
- Please fully charge the battery before each use.
- Do not leave the battery pack uncharged or fully charged for long periods of time.
- Do not completely drain the battery while running the vehicle. Do not charge the battery under any wet or damp conditions. Only charge in dry conditions.

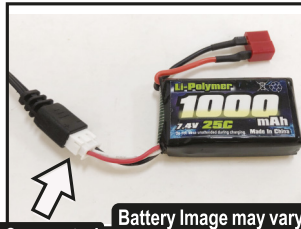

Connected

Battery Image may vary from your battery.

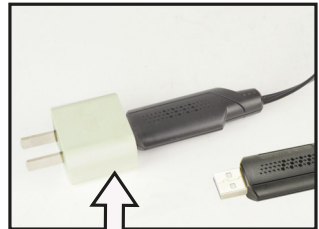

Smart phone AC Power adaptor (not Included)

During charging, the red LED is on solid, which monitors the charging process.

The red LED will go off after the battery pack has been fully charged.

**Charging Duration:** Li-ion Battery Pack 7.4V, 800 mAh (Approx. 2-2.5 hours),

**Soft Pack Li-Po Battery Pack 7.4V, 1000mAh (Approx. 2.5 hours)**

Tip: Smart phone AC POWER adaptors (5V, 2A) can be applied to cut down charging period.

**The red LED flashes, which indicates:**

- 1) USB charging cable is connected with the battery pack but not being plugged on the charging slot.
- 2) Non-rechargeable battery pack is connected
- 3) Not able to charge as the battery pack is over-discharged.
- 4) USB cable is in an unstable connection.



# Maintenance:

**We strongly recommend that you check and maintain the vehicle after use. Please read and understand the list below which will facilitate you.**

- Disconnect and remove the batteries from the car and the radio controller when not in use.
- Do not leave the rechargeable battery pack uncharged or fully charged for a long time.
- Check if there is any obvious damage after each use.
- If the vehicle runs noisily check to see if there is any broken or slipped gears and check if there is a clogged drive train.
- Check if the wheels are well tightened after use.
- Check if there are any loose screws in the chassis.
- Check if there are not frayed, damaged, loosened wires, or connectors.
- Check if the steering servo is in good order. It may wear out over time and require replacement.
- Check if there are any objects getting twisted in the drive train. Replace them if necessary.
- Check the motor and motor wires after use. Never attempt to re-assemble the motor.
- Clean the car body and chassis with a soft lint-free cloth.
- Store the vehicle in a clean, cool, and dry place out of children's reach.

# Troubleshooting:

## **A.The vehicle does not work at all:**

- 1) Check to ensure that radio controller and car are switched on.
- 2) Check if there are damaged parts/wires/connectors, repair or replace if necessary.
- 3) Car battery is flat. Charge the battery pack.

## **B.The vehicle runs slowly:**

- 1) Car battery is flat. Charge the battery pack.
- 2) Check if the vehicle is properly geared and no dirty or stripped gears are found. Make sure there is a reliable gear mesh for motor pinion and the spur gear.
- 3) Check if there is something stopping the moving parts and clean them immediately.

## **C. The throttle works but not the steering:**

- 1) Check if the servo feels jammed, and try centering it gently if it is the case.
- 2) Check if the servo link is loose or the servo breaks. Repair or replace if needed.

## **D. It steers, but throttle is uncontrollable:**

- 1) Check if there are damaged parts in the overall drive train.
- 2) Check the battery power both for radio controller and the car.

## **E. The vehicle runs noisily:**

- 1) Check gear mesh between spur gear and motor pinion.
- 2) Check if there are stripped and/or dirty gears.
- 3) Check if there are some parts getting damaged in the overall drive train.

## **F. The vehicle is found one direction's steering travel is not same to the other.**

Please tune the Steering Trim until Steering Center Point is fixed.

## **G. Not able to charge the batteries:**

Check if either the charger or the batteries is damaged, or batteries are over-discharged.

# Headlight Installation

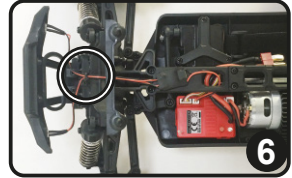
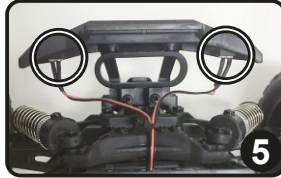
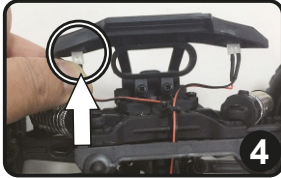
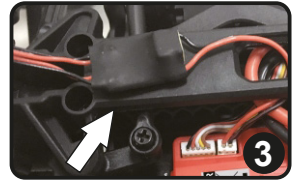
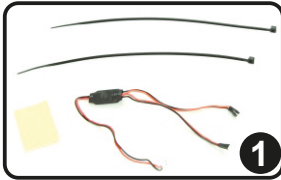

1) The headlight, which is provided as a gift in the box, is not installed on the car.

2) Please take out the headlight, the zip ties, and the adhesive tape from the box.

(See Photo 1)

3) Please plug the headlight plug into the slot on the ESC/Receiver. (See Photo 2).

Note: Do not force while plugging or unplugging.

4) Please apply the adhesive tape to the headlight board and stick it on the upper deck as shown in Photo 3.

5) Gently insert the headlights into the slots on the back of the front bumper. Make sure they are in place. (See Photo 4 and Photo 5)

6) Please keep the wires in order and bind them up with the aid of the zip ties. (See Photo 6)



## PART LIST-1

M16001	M16002	M16003	M16004
			
Chassis	Front Gear Box Top Housing	Rear Gear Box Top Housing	Front Bumper Assembly
M16005	M16006	M16007	M16008
			
Rear Bumper Assembly	Front Lower Suspension Arms(Left/Right)	Front Upper Suspension Arms(Left/Right)	Rear Lower Suspension Arms(Left/Right)
M16009	M16010	M16011	M16012
			
Rear Upper Links+ Steering links+Servo Link	Shock Towers(Front and Rear)	Body Posts	Shock Absorbers(2P)
M16013	M16014	M16015	M16016
			
Steering Hubs	Rear Hubs	Front/Rear Drive Shafts	Diff. Outdrive Cups
M16017	M16018	M16019	M16020
			
Steering Bushes+ Ackerman Plate	Diff. Complete (Front/rear)	Servo Top Plate+ Motor Guard	Spur Gear+Drive Pinions

*For continuous improvements , the images may vary from your received model.*

## PART LIST -2

M16021	M16022	M16023	M16024
			
Servo Saver Assembly	Centre Drive Shaft	Front Upper Suspension Hinge Bolts	Front/Rear Lower Suspension Hinge Pins
M16025	M16026	M16027	M16028
			
Rear Hub Pins (4P)	Drive Shaft Pivot Pins (8P)	Diff. Assembly	Steering Posts (4P)
M16029	M16030	M16031	M16032V2
			
Diff. Posts + Pins	Steering Pivot Balls (8P)	Plastic Pivot Balls Complete	Electronic Speed Control/Receiver
M16033	M16034V2	M16035	M16036
			
Servo (5-wire)	Motor 390	Motor Pinions(14T) + Set Screw	Motor Heatsink
M16037T	M16055	M16039	M16040
			
Battery Pack(Li-ion 7.4V,800mAH), W/Dean Plug	Wheels Complete	Truck Body (orange)	Truck Body (Blue)

For continuous improvements , the images may vary from your received model.

## PART LIST-3

M16050	M16038	12010	P010
			
Battery Binding Strap	Wheels Complete	Wheel Hex.	Zip Ties (8P)
18859E-E001	793127	635953	M16060
			
USB charger	Ball Bearings (φ7.93*12.7*3.95mm)	Ball Bearings (φ6.35*9.53*3.17mm)	Wheel Lock Blots
5007	5029	5058	5088
			
Pan head Self Tapping Screws PBHO2*8mm	Pan head Self Tapping Screws PBHO2.6*10mm	Countersunk Screws KM2.5*8	Countersunk Self Tapping KBHO2.6*12mm
S103	S128	S161	S204
			
Set Screw 2.5x2.5mm	Countersunk Self Tapping Screws KBHO2.3*6mm	Pan head Self Tapping Screws PBHO2.6*12mm	Pan head Self Tapping Screws PBHO2*12mm
S225	S226	S227	16014
			
Pan head Self Tapping Screws PBHO2.3*4mm	Countersunk Self Tapping Screws KBHO2.3*12mm	Flange Head Self Tapping Screws PWTWO.6*12mm	Steering Hub Step Screws

For continuous improvements , the images may vary from your received model.

## PART LIST-4

H165	M16061		
 <p>Body Clips (6 pairs)</p>	 <p>Headlight LED</p>		
M16100A	M16101	M16102	M16103
<p><b>OPTIONAL</b></p>  <p>Aluminum Capped Oil Filled Shocks</p>	<p><b>OPTIONAL</b></p>  <p>Heavy Duty Center Drive Shaft + Outdrive Cups+ Pins+Screws (suited for metal spur gear version)</p>	<p><b>OPTIONAL</b></p>  <p>Machined Metal Spur Gear</p>	<p><b>OPTIONAL</b></p>  <p>Machined Metal Diff. Gears+ Diff. Pinions</p>
M16104	M16105	M16106	M16107
<p><b>OPTIONAL</b></p>  <p>Machined Metal Diff. Outdrive Cups+Pins</p>	<p><b>OPTIONAL</b></p>  <p>Metal Front CVD Shafts +Pins+Lock Nut M4</p>	<p><b>OPTIONAL</b></p>  <p>Metal Rear Dogbones</p>	<p><b>OPTIONAL</b></p>  <p>Metal Rear Wheel Shafts +Pins+Lock Nut M4</p>
M16108	M16109	M16110V2	M16111
<p><b>OPTIONAL</b></p>  <p>Wheelie Bar Assembly</p>	<p><b>OPTIONAL</b></p>  <p>Servo (3-wire plug, for brushless Version)</p>	<p><b>OPTIONAL</b></p>  <p>Brushless ESC/Receiver</p>	<p><b>OPTIONAL</b></p>  <p>Brushless Motor</p>
M16035T	M16150		
<p><b>OPTIONAL</b></p>  <p>Motor Pinions(13T) +Set Screw</p>	<p><b>OPTIONAL</b></p>  <p>Li-PO Soft Pack 7.4V, 1000mAh, 25C (Dean-Plug)</p>		

For continuous improvements , the images may vary from your received model.

# ASSEMBLY VIEW-1

## SHOCK ASSEMBLY

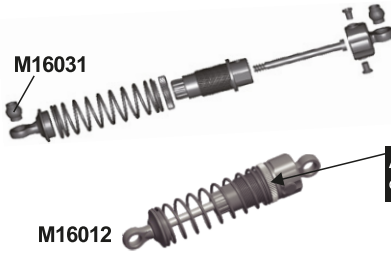

**Adjusted Ring:** Rotate this ring to adjust spring tension for desired suspension travel.

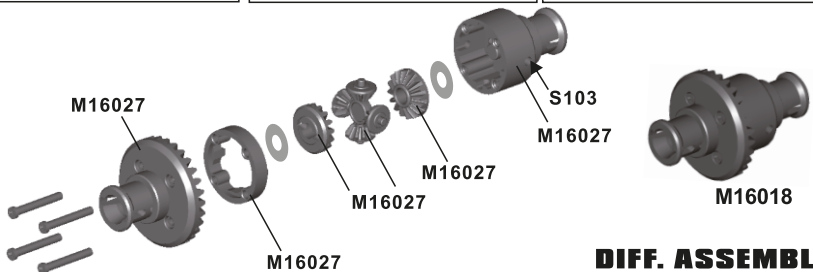
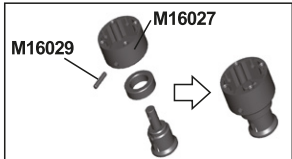
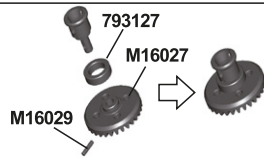
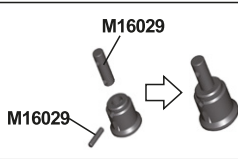

## DIFF. ASSEMBLY

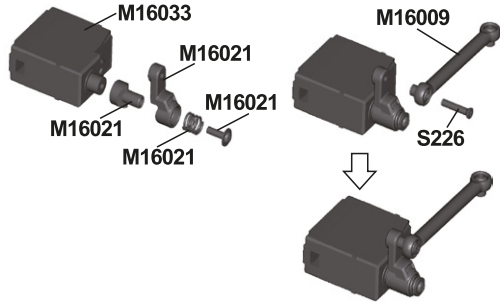
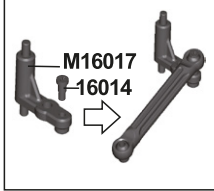
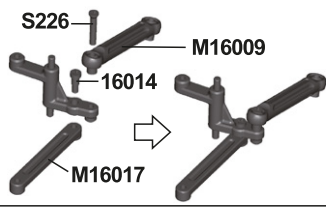

## STEERING ASSEMBLY

## ASSEMBLY VIEW-2

### CENTER DRIVE ASSEMBLY

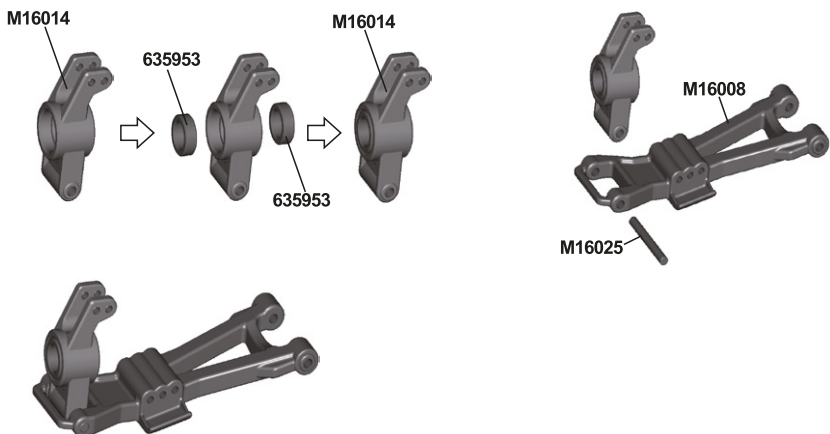
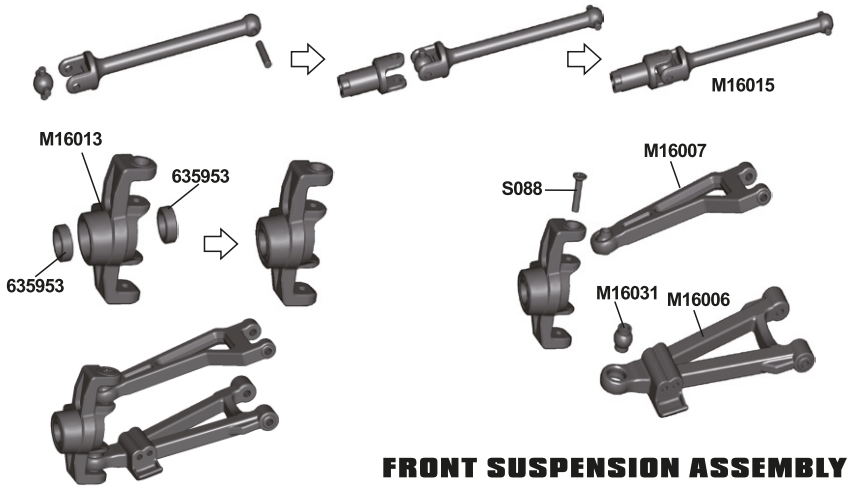
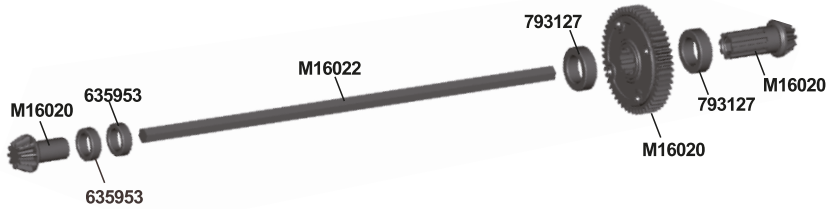

## ASSEMBLY VIEW-3

### FRONT/REAR SHOCK TOWER BODY POST ASSEMBLY

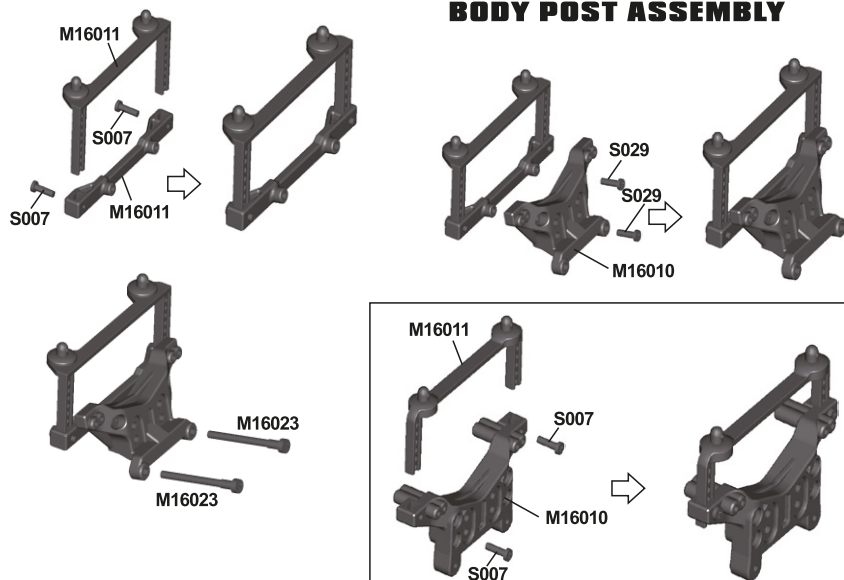

### BUMPER ASSEMBLY

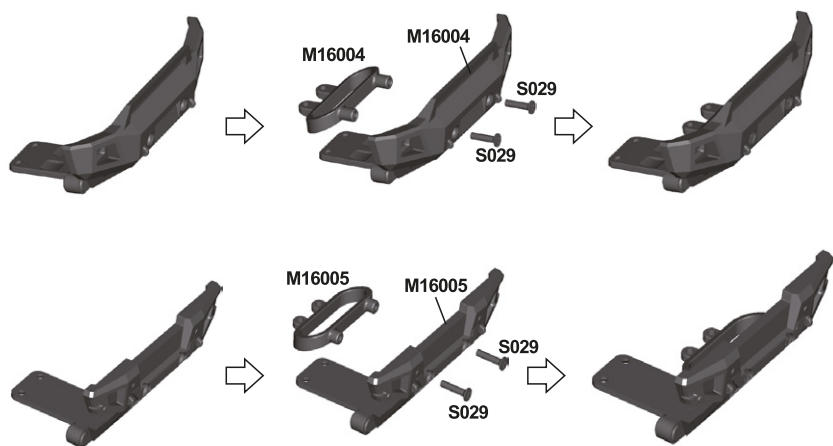



## ASSEMBLY VIEW-4

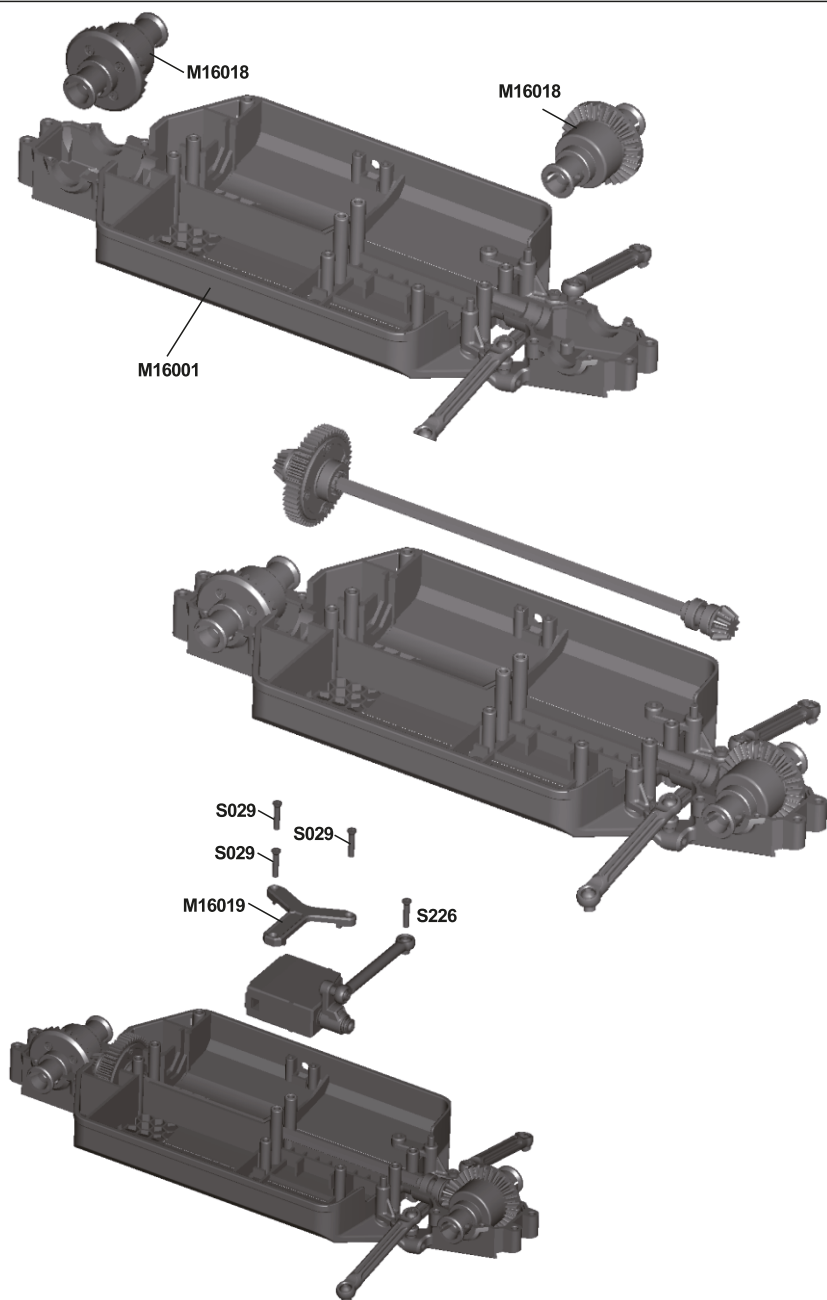

# ASSEMBLY VIEW-5

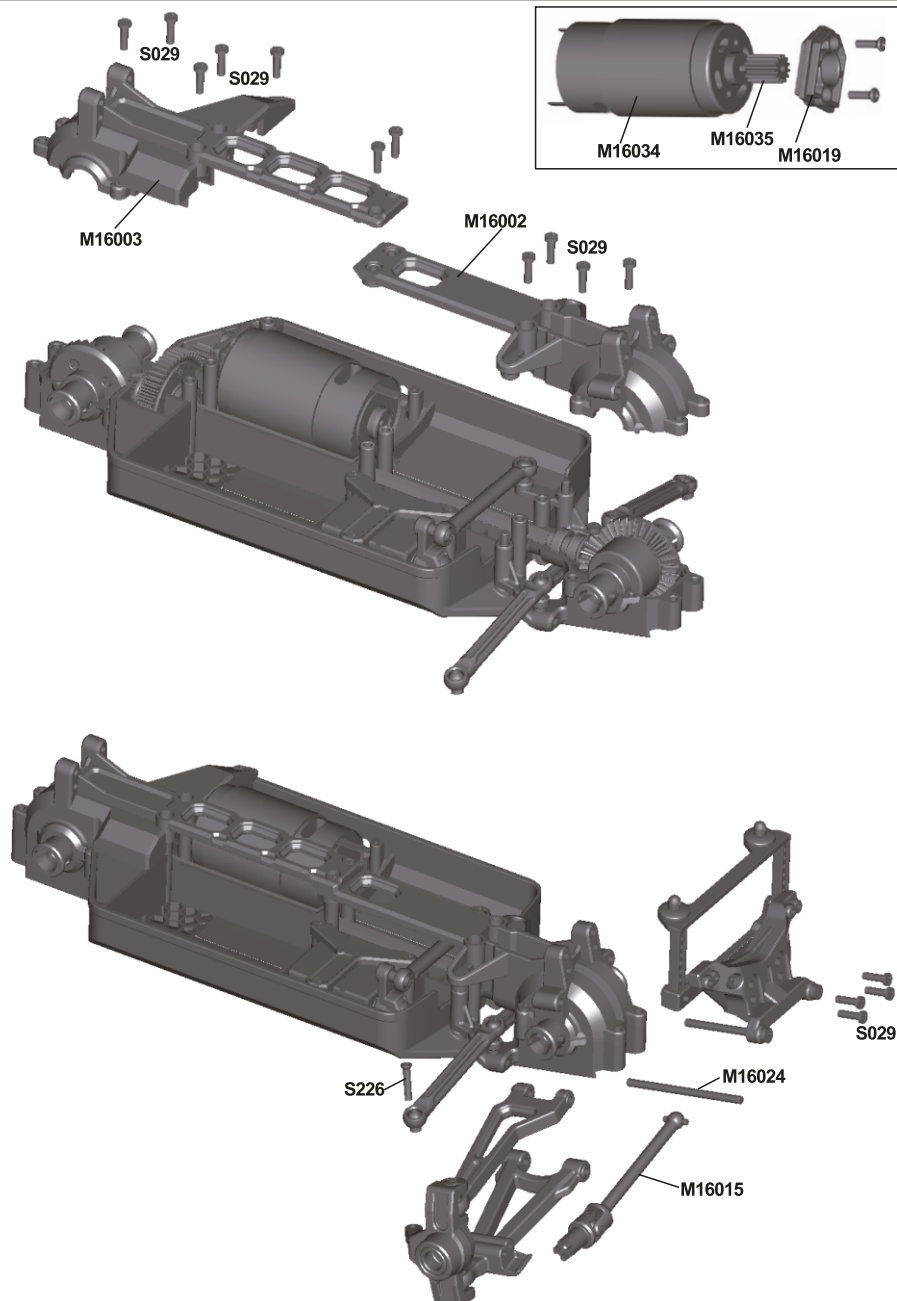

## ASSEMBLY VIEW-6

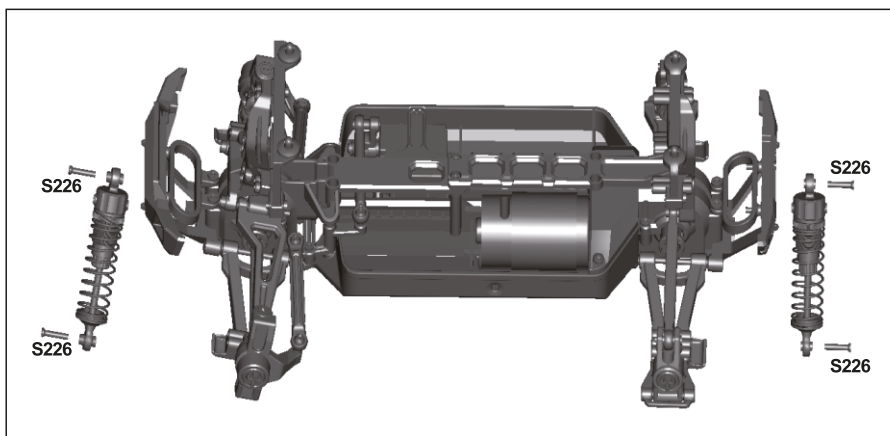
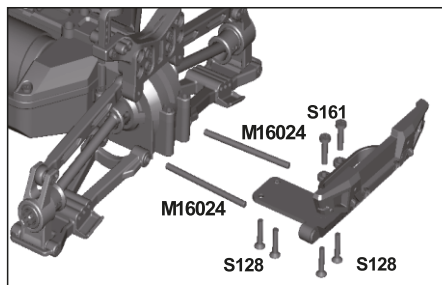
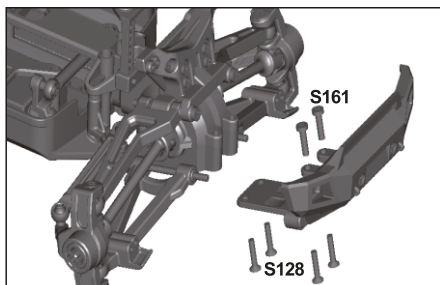
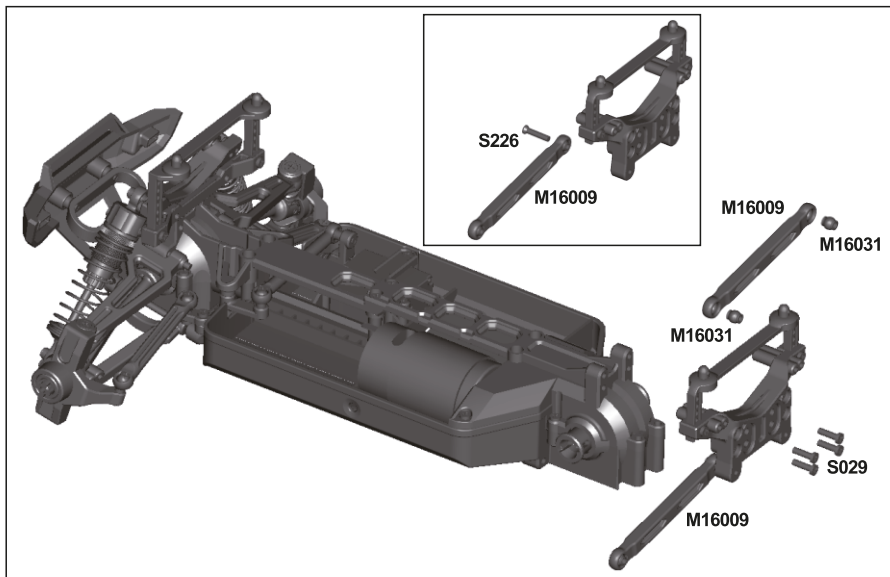

## ASSEMBLY VIEW-7

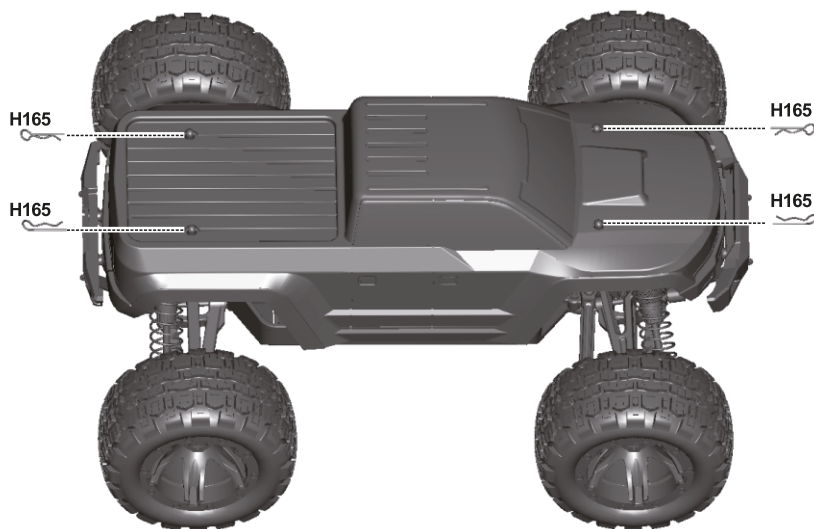
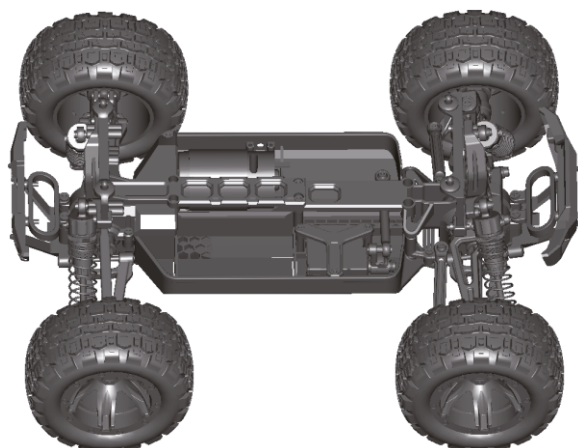
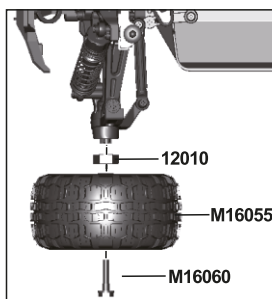

# 1/16TH SCALE 4WD ELECTRIC POWER RACE TRUCK

Thank you for purchasing our product.

If you are not familiar with radio controlled model, we **STRONGLY** recommend that you seek the experts for reliable advice. Wish you safe enjoyment.



This product **MUST** be handled with due care. We understand high speed is our long pursuit.

However, safety is also the regulation to observe.

Please operate your car in a spacious area and do not operate it where people are congested.

Do not attempt to assemble or disassemble the electronic units, and when it is not in use, you **MUST** keep it out of children's reach.

This product is fully assembled at factory. Malfunction and damage that result from misuse and/or abuse will void the warranty. Contrived modification will also void the warranty.