

PRODUCT MANUAL

4WD OFF ROAD CAR

2.4GHz RADIO SYSTEM

1:10 Brushless RC CAR

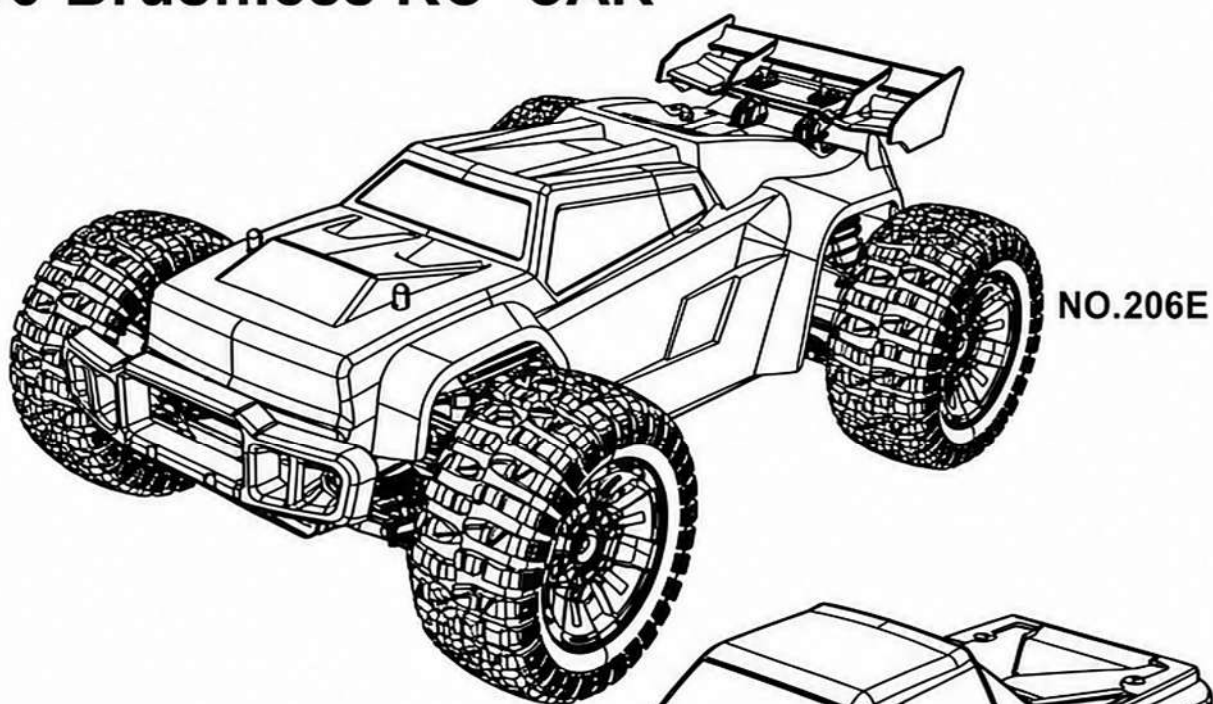

NO.206E

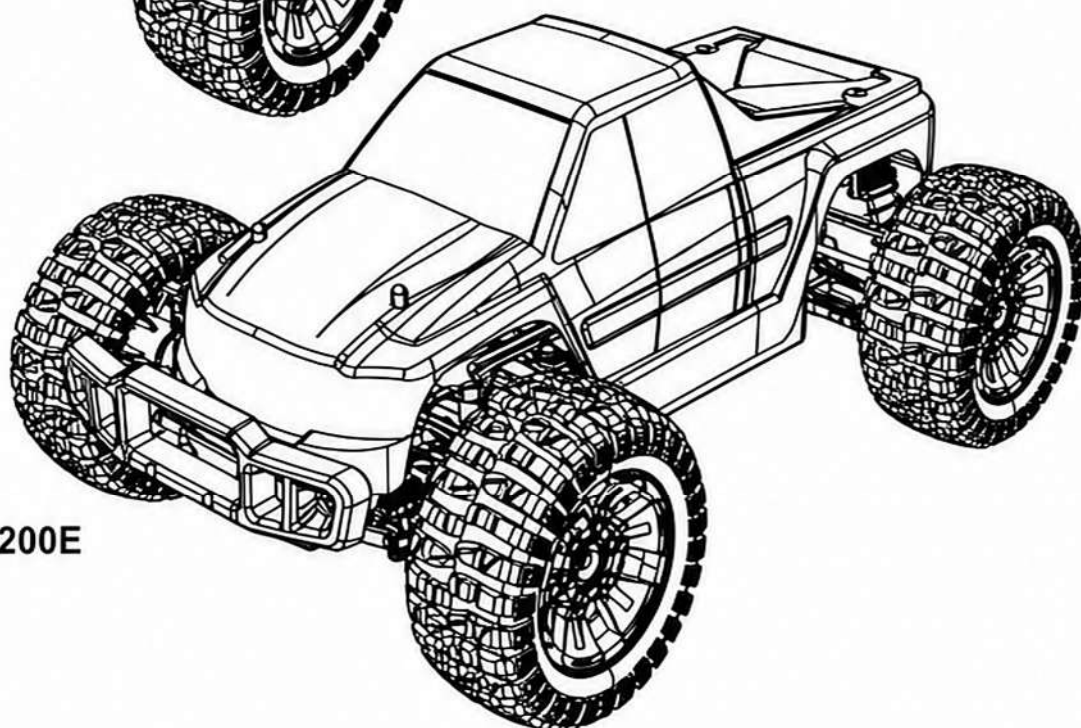

NO.200E



WARNING:





PLEASE READ THE INSTRUCTION MANUAL CLEARLY BEFORE OPERATING THE PRODUCT

PREFACE

To make your experience with this remote control car as easy and convenient as possible, please read the instructions provided before using the product. Enjoy and have fun with the product while keeping the manual for future maintenance and reference.

1. In order to protect the legitimate rights and interests of users, please be sure to carefully read the contents of this manual before using this product.
2. When using this product, please be sure to strictly observe and perform the requirements which includes but not limited to the instructions and safety guidelines. For any personal injury, accident, property loss, legal dispute, or any other adverse event causing a conflict of interest resulting from the use of the product or any irresistible factors that are in violation of the safety instructions, the user shall bear the related responsibilities and losses. ENOZE will not take any responsibility.
3. Once you start using the product, you are deemed to have read, understood, recommended, and accepted all terms and contents of the instructions (including disclaimers, safety instructions, warning instructions, etc.) included with this product.
4. In case you are having challenges on any aspect of the product, may it be operation or maintenance, please contact your local sales agent or contact customer support at ENOZE.

PACKAGE CONTENTS

					
RC Car	Remote Control	USB Charging Cable	Battery	Product Manual	Accessory package

CHARGING

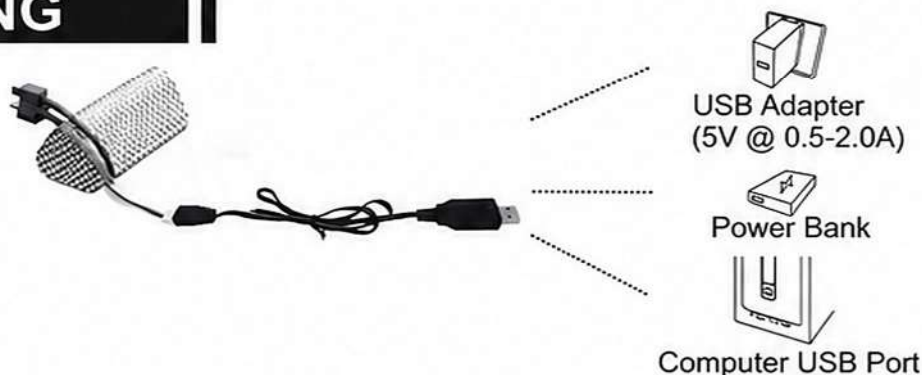

The battery isn't fully charged when it's made. When the car **battery low**, the car will start the LVC (Low Voltage Cutoff) protection function to protect the battery, the car can **only turn, not forward and backward**. Please charge the battery.

1. Plug the USB charging cable into the USB charging port of the computer, power bank or USB adapter (5V@ 0.5~2.0A).
2. Connect the battery wire to the USB charging cable.
3. Charging time: about 360 minutes.
4. The green indicator light on the USB charging cable will flash when it is charging and will turn steady on once fully charged.

ATTENTION:

- Please keep the battery in sight when charging. DO NOT put the battery on a flammable surface.
- If battery pack and USB charging cable are damaged, immediately stop using it and replace the accessories as soon as possible.

RC CAR'S DETAILS

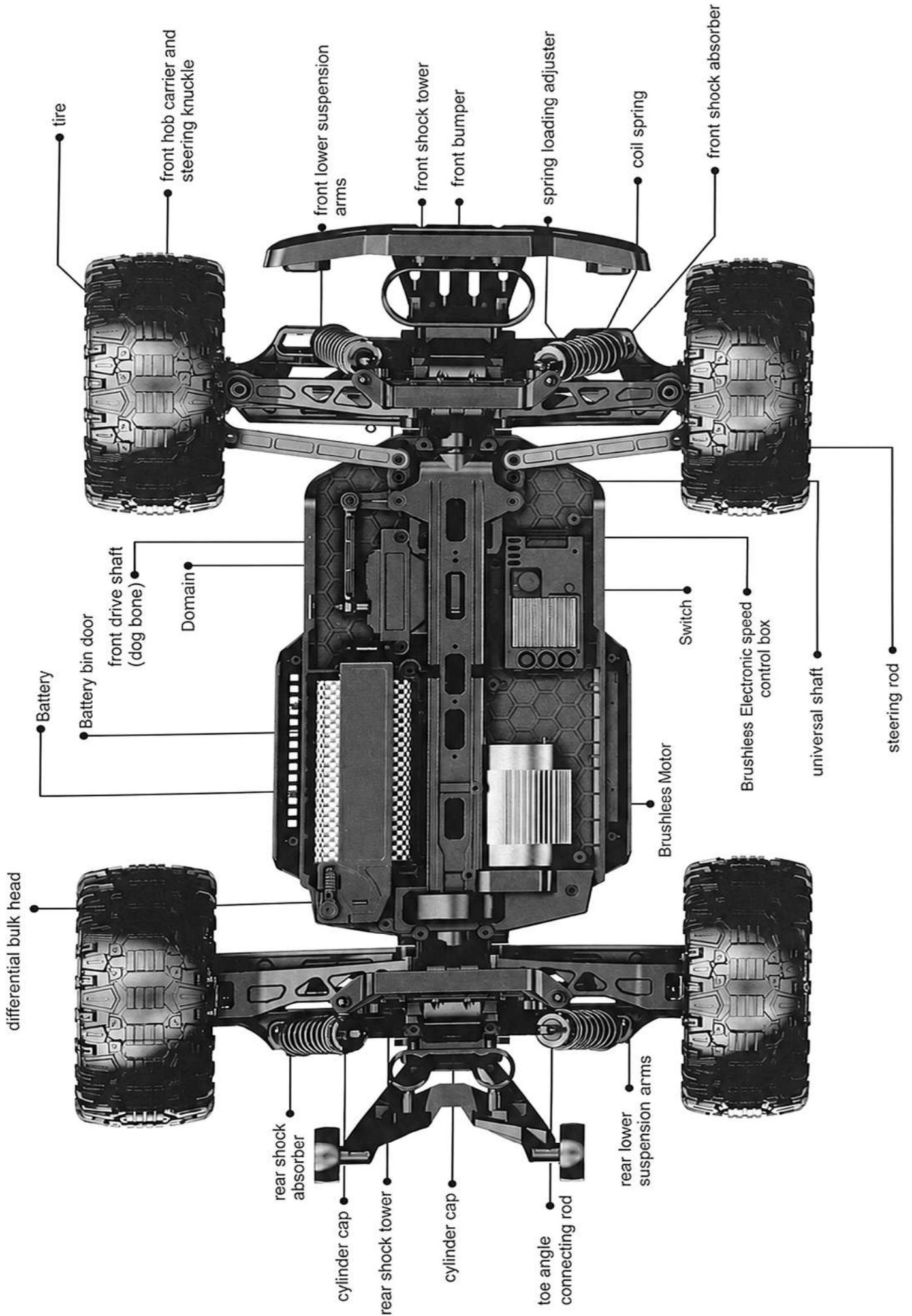

REMOTE CONTROL FUNCTIONS

REMOTE CONTROLLER

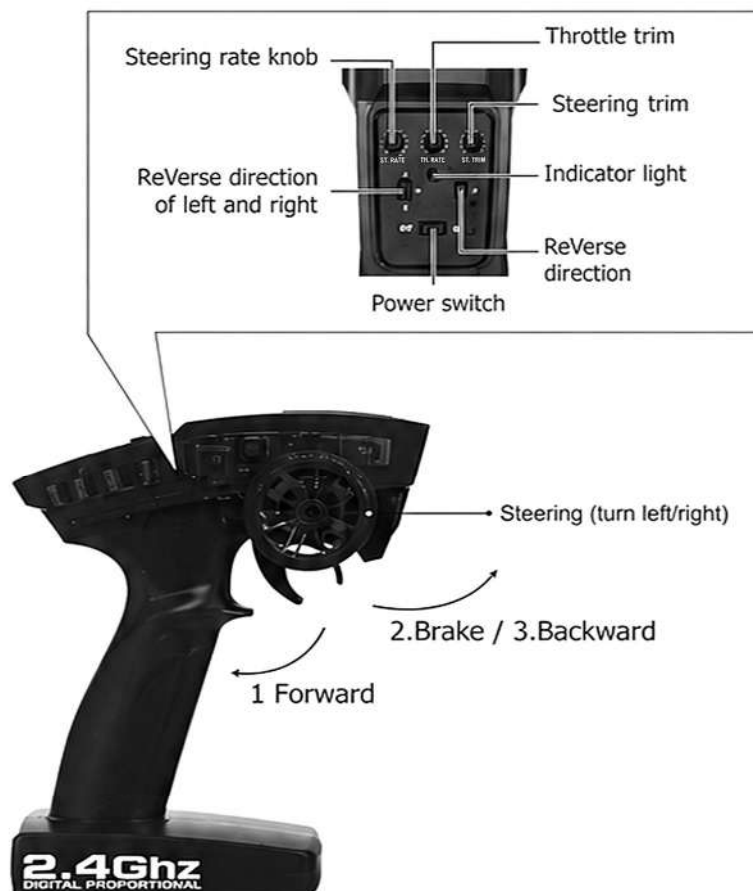

Remote Battery:

- ① Push the battery cover out.
- ② Insert 3X1.5VAA batteries (not included) in the correct direction.
- ③ Push the battery cover in.

If the remote will not be used for a long time, make sure to turn it off and remove the batteries. When the battery of the remote control is low, the indicator light of the remote control will flash slowly.

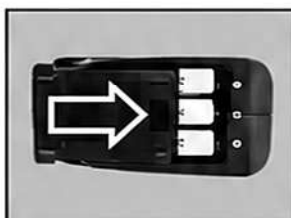

1. When the trigger is pulled back, the vehicle advances
2. When the vehicle is moving forward, push the trigger forward and the vehicle will brake;
3. When the trigger on the remote control returns to the midpoint, push the trigger forward again and the vehicle will retreat.

REMOTE LED CODES

LED color/pattern	Name	Hints
Red light always on	Normal driving pattern	
Red light with slow flash (on at 0.5s/off at 0.5s)	Hint of low power	For more information m please refer to operation of putting new battery into remote
Red light with quick flash (on at 0.125s/off at 0.125s)	Connect failed/error	If transmitter and receiver are bound unsuccessfully, please close the remote system and restart for recovering normal operation. Please check exceeding scope, low battery or damaged antenna if the connection is failed.

BATTERY INSTALLATION

INSTALL THE BATTERY PACK FOR YOUR MODEL

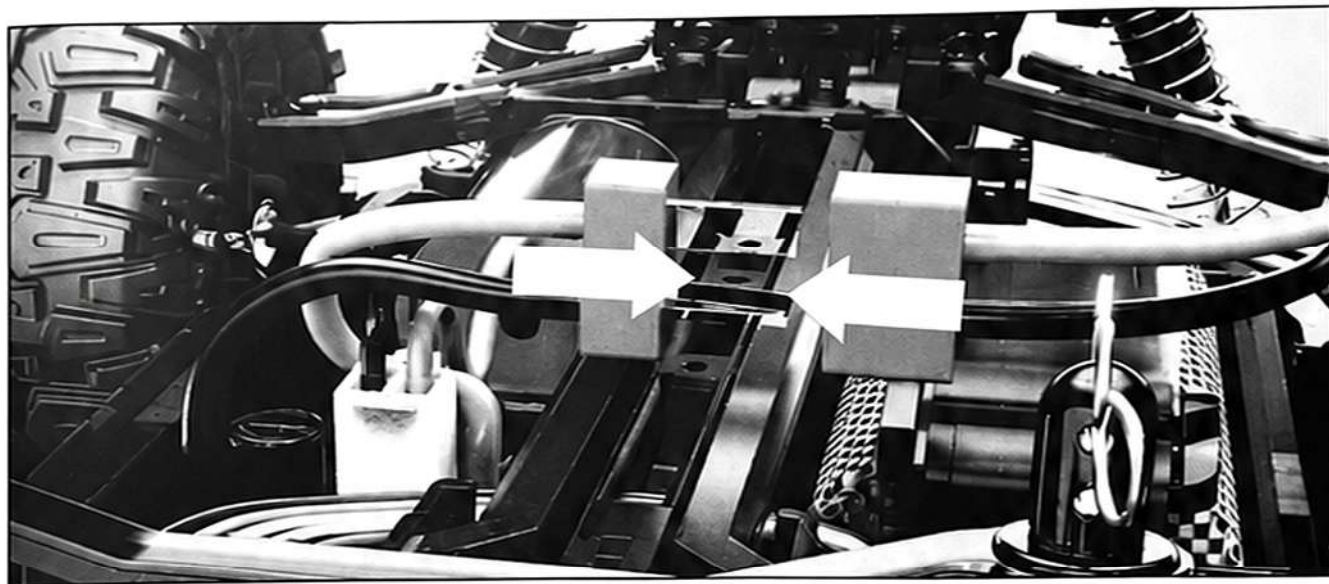

RC Car Battery:

Connect the battery outlet to the cable in the battery compartment, then insert the battery to the battery compartment.

If the car will not be used for a long time, make sure to turn it off and remove the battery.

MAXIMUM SPEED CONTROL

Turn the speed switch counterclockwise to reduce the maximum speed of the car.

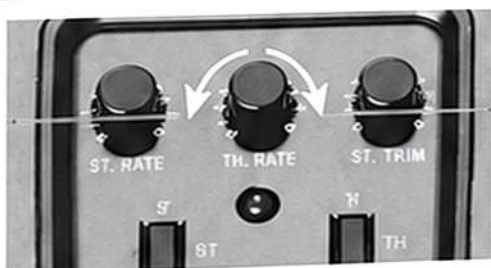

Turn the speed switch clockwise to increase the maximum speed of the car.

REMOTE CONTROL BATTERY

FINE TUNING KNOB OF STEERING

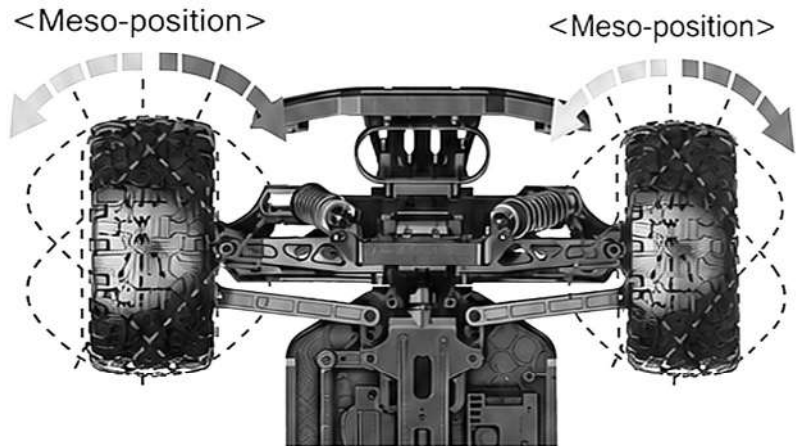
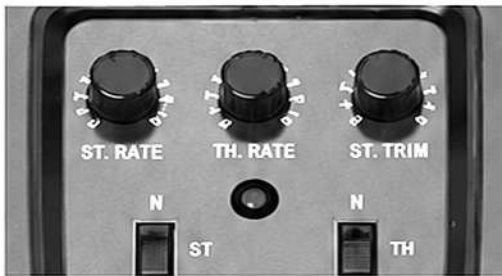

OPERATING YOUR CAR

BEGINNING

- ① Make sure the battery is charged.
- ② Insert batteries to the car and the remote.
- ③ Turn on the remote power switch, then press and hold the car power switch to turn on the car.
(DO NOT pull the throttle trigger during pairing)
- ④ Both will automatically pair. (The remote power indicator and the car power indicator will flash while waiting for the pairing process and will turn solid once pairing has been successful)



NOTE! BE SURE TO CORRECT CONNECTION BETWEEN REMOTE AND CONNECTOR BEFORE OPERATING THE CAR.

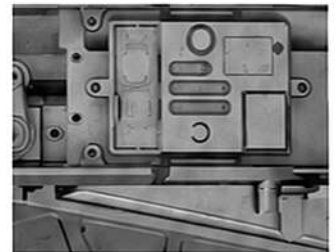

Figure 1



Figure 2

OPERATIONAL CONTENTS

- Pull the trigger to allow the car to advance slowly, and advance quickly when pulling again.
- Push the trigger forward to stop the car, and driving/reserving in the opposite direction when pushing again.
- When colliding, loosen the trigger.
- When the battery is getting low, the car will roll until it stops. The car is equipped with LVC to protect the battery.



FREQUENTLY ASKED QUESTIONS

QUESTION	CAUSE	SOLUTION
No match or can't control it	<ol style="list-style-type: none"> 1. The car battery or remote control battery is completely dead 2. Out of remote range 	<ol style="list-style-type: none"> 1. Replace charged battery 2. Repair and keep in remote distance
Can't go forward or reverse	<ol style="list-style-type: none"> 1. Low battery 2. The car shorted out when it got wet 3. Poor contact between motor and electronic regulator 	<ol style="list-style-type: none"> 1. Charging 2. Let the car dry completely 3. Reconnect the connection wire between the motor and the electronic regulator
Can't turn left or turn right	<ol style="list-style-type: none"> 1. Low battery 2. The car shorted out when it got wet 3. Poor contact between steering gear and electronic regulator 	<ol style="list-style-type: none"> 1. Charging 2. Let the car dry completely 3. Reconnect the connection wire between the steering gear and the electronic regulator
It won't charge	<ol style="list-style-type: none"> 1. The output voltage or current of the power supply is too high 2. The charging cable or battery is broken 	<ol style="list-style-type: none"> 1. The output voltage and current of the power supply should be 5V 0.5~2A 2. Contact ENOZE Customer Service
Something's missing or broken		<ol style="list-style-type: none"> 1. Contact ENOZE Customer Service
The wheels turn on their own	Pull the throttle trigger during pairing	Repair without pulling the throttle

SPECIFICATIONS

DEVICE EXPLOSION DIAGRAM

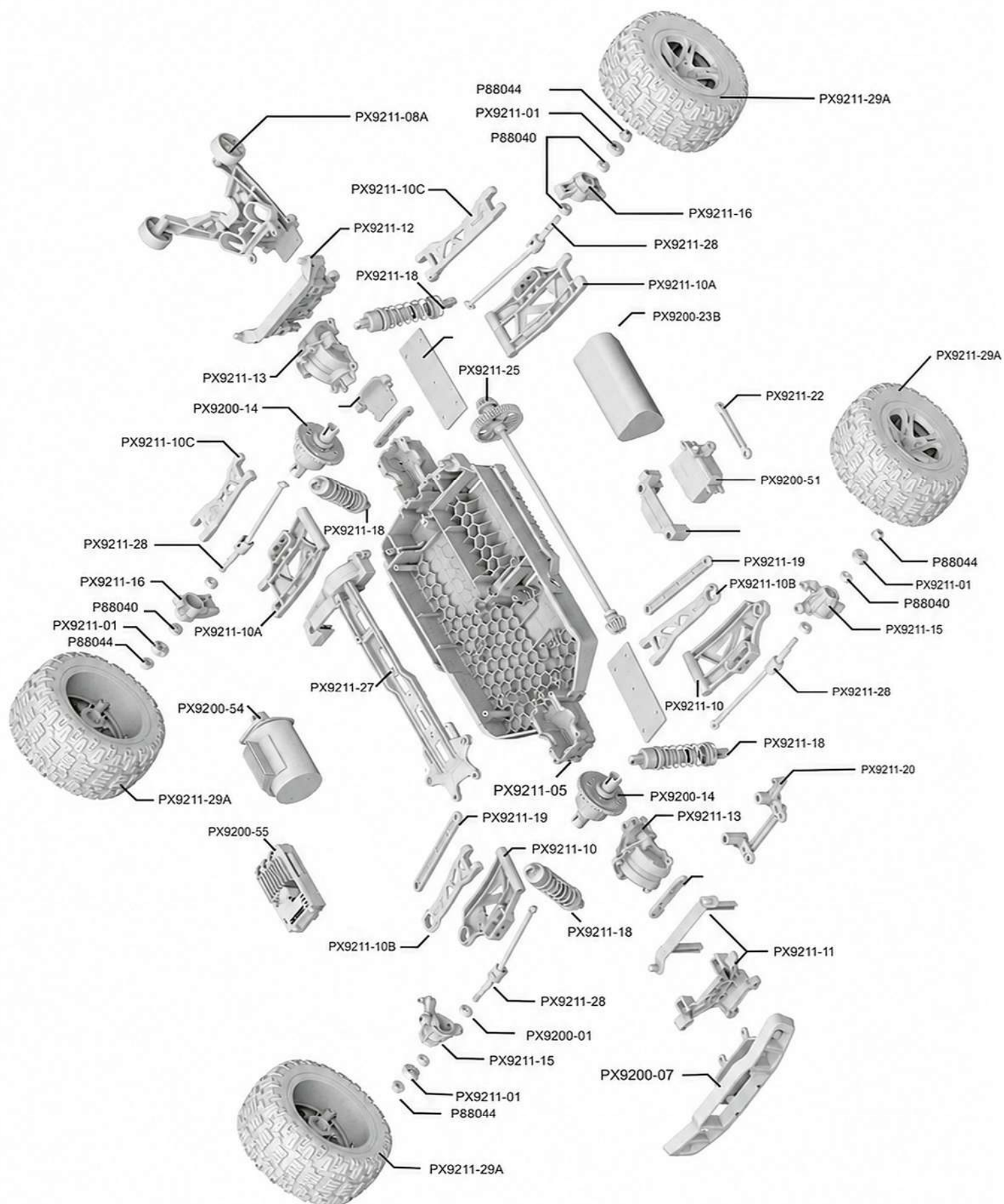

RETAIL ACCESSORY VIEW

PX92001



Φ2.6*12PB Round Head Screw

PX92002



Φ2.6*25PB Round Head Screw

PX92003



2.6*12*7PWB

PX92004



Φ3*12 Round Head Screw

PX92005



Φ2.3*10PB Screw

PX92006



Φ2.6*12PB Screw

PX92007



Φ1.7*8PB Screw

PX92008



Chassis Sheet Steel

PX92009



Φ2.3*14PB Screw

PX920010



Wheel Hex

PX92011



Φ8*10*3 Ball Bearing

PX92012



Φ3*48 Front/Rear Lower Suspension Pin A

RETAIL ACCESSORY VIEW

PX9211-05



Chassis

PX9211-06



Tube-style bumpers

PX9211-07



9200-Front/Rear Bumper

PX92014



Tie Bar

PX9211-10B



Lower Suspension Arm

PX9211-10



Front Shock Tower and Body Post

PX9211-10C



Rear Shock Tower and Body Post

PX9211-10A



Rear Shock Tower and Body Post

PX9211-11



Front Shock Tower and Body Post

PX9211-12



Rear Shock Tower and Body Post

PX9211-13



Front/Rear Gear Box

PX9211-14



Diff Main Gear Complete

PX9211-15



Front Steering Carrier

PX9211-16



Rear Upright

PX9211-18



Front/Rear Shock Absorber

PX9211-19



Servo Link

PX9211-20



Steering Arm Complete

RETAIL ACCESSORY VIEW

PX9211-23A



Battery

PX9211-24



Battery Cover

PX9211-25



Drive Shaft Assembly

PX9200-54



Brushless Motor

PX9211-27



Motor Layering

PX9211-28



Universal Drive Joint

PX9211-29A



Wheel Complete

PX9211-08A



Vacuum Wheel Complete

PX9211-30A



ESC

PX9200-55



ESC PRO

PX92008



Chassis Sheet Steel

PX9200-34



3MM Crossrip Screwdrivers

PX9200-35



2MM Hexagon Wrench

PX9200-36



2.4G Transmitter

PX9200-36A



2.4G Transmitter

PX9200-51



SERVO(3 wire)

PX9200-38



Socket Wrench

PX9200-39



Motor Gear (22T)

PX9200-40



Motor Heat Proof Cover

PX9200-37A



11.1V USB

PX9200-23B



11.1V Battery

WARNINGS

1. According to the instructions provided on the manual. Some part needs to be assembled and adjusted by adults.
2. Please use under the guidance of an adult.
3. Please promptly put away the packing materials so as not to cause harm to children.
4. Do not operate on a location where water is trapped or under the rain. Parts of the product may malfunction if exposed to water.
5. Do not touch the rotating wheel to avoid injury.
6. The product contains small parts that may pose a risk of ingestion or suffocation.
7. To remotely control the product on the road or in a crowd to avoid accidents.
8. It is necessary to periodically check the charging USB cable, plug, housing and other components, and immediately unplug if found to be damaged.
9. This product can only use the factory configured USB cable to charge the product battery.
10. USB cable, battery box, and battery must be inserted into the same specified power supply as the product symbol.
11. The USB charging cable and the battery is not a toy.
12. Disconnect the rechargeable USB cable before cleaning the toy.
13. If you observe electrical charges during product usage, turn off the device immediately.
14. When installing or replacing the battery, pay attention to the correct polarity of the battery.
15. The remote control car uses a 7.4V Lithium battery.
16. It is strictly prohibited do the following actions such as but not limited to disassemble, modify, crash, puncture, drop, throw in a fire or any other means of causing damage to the product to avoid harm to the user and other participants.
17. Do not expose the battery to prolonged exposure to sunlight to prevent danger.
18. It is advisable to store the battery at a temperature below 30°C. Do not store it in a place with heat, high temperature, or humidity to avoid danger.
19. Non-rechargeable batteries cannot be charged.
20. When charging a rechargeable battery, adult supervision is required.
21. The rechargeable battery should be removed from the toy before charging.
22. Do not mix old and new or different types of batteries.
23. Only use the USB cable configured by this product when charging the battery.
24. Do not disassemble the battery or modify the battery to avoid risk of fire or explosion.
25. After the battery is used, it should be taken out of the remote control car. After cooling the battery, you can then charge it and placed it on a safe location. Unplug the battery outlet from the USB charging cable when not in used and disconnect the power line.
26. Stop using the battery as soon as it gives a foul smells or suddenly becomes hot, deformed, discolored, or otherwise abnormal during use or charging.
27. After the battery of the remote controller runs out, battery temperature is usually high and would recommend to wait for 30 minutes before charging the battery again. Otherwise, it may damage the battery.
28. Drained batteries should be removed immediately.
29. Do not cause the electrical supply of the wiring port to short circuit.
30. If you do not use the product for a long time, remove the batteries of the remote control car and remote control.
31. instructions contains important product information, please give time to read for better product experience.

GENERAL INFORMATION

FCC Notice:

This device complies with Part 15 of the FCC Rules.

Operation is subject to the following two conditions:

- (1) This device may not cause harmful interference, and
- (2) This device must accept any interference received, including interference that may cause undesired operation.

NOTE: This equipment has been tested and found to comply with the limits for a Class B digital device, pursuant to Part 15 of the FCC Rules. These limits are designed to provide reasonable protection against harmful interference in a residential installation. This equipment generates uses and can radiate radio frequency energy and, if not installed and used in accordance with the instructions, may cause harmful interference to radio communications. However, there is no guarantee that interference will not occur in a particular installation. If this equipment does cause harmful interference to radio or television reception, which can be determined by turning the equipment off and on, the user is encouraged to try to correct the interference by one or more of the following measures:

- Reorient or relocate the receiving antenna.
- Increase the distance between the equipment and receiver.
- Connect the equipment into an outlet on a circuit different from that to which the receiver is connected.
- Consult the dealer or an experienced radio/TV technician for help.

WARNING: Changes or modifications not expressly approved by the party responsible for compliance could void the user's authority to operate the equipment.

RF Exposure

The equipment complies with FCC radiation exposure limits set forth for an uncontrolled environment. This device should be installed and operated with minimum distance 20cm between the radiator & your body.

IC Notice:

This device complies with Canada Industry licence-exempt RSS standard(s). Operation is subject to the following two conditions:

- (1) this device may not cause interference; and
- (2) this device must accept any interference. Including interference that may cause undesired operation of the device.

CAN NMB-3 (B)

RF Exposure

Radiation Exposure Statement:

This equipment complies with IC radiation exposure limits set forth for an uncontrolled environment. This equipment should be installed and operated with minimum distance 20cm between the radiator & your body.

BATTERY WARNING:

1. Failure to follow all the instructions may result in serious injury, irreparable damage to the battery and may cause a fire, smoke or explosion.
2. Always check the battery's condition before charging or using it.
3. Replace the battery if damaged, gives a foul odor or show signs of overheating, discoloration, deformation and leakage.
4. Never use anything other than the approval charger the battery. Always use a balancing charger for battery. It is recommended that you do not to use any other charger than the one provided with the product.
5. The battery temperature must never exceed 60°C (140°F) otherwise the battery could be damaged or ignite.
6. Never charge on a flammable surface, near flammable products or inside a vehicle (preferably place the battery in a non-flammable and nonconductive container).
7. Never leave the battery unattended during the charging process. Never disassemble or modify the housing's wiring, or puncture the cells. Always ensure that the charger output voltage corresponds to the voltage of the battery. Do not overcharge the batter that may cause short circuit.

GENERAL INFORMATION

8. Never expose the battery to moisture or direct sunlight, or store it in a place where temperatures could exceed 60°C(car in the sun, for example).
9. Always keep it out of reach from children.
10. Improper battery use may result in a fire, explosion or other hazard.
11. Non-rechargeable batteries are not be charge again. Rechargeable batteries are only to be charged with the supervision of an adult.
12. Different types of batteries or new or used batteries which are different are not be mixed.
13. Batteries are to be inserted with the correct polarity.
14. The supply terminal should be used well to avoid short circuit. Examination of the transformer and battery charger regularly is encouraged to check any damage in the cord, plug, enclosure and other parts. If damage is observed, it must not be used until it has been repaired.
- 15.The packaging has to be kept since it contains important information.
- 16.The toy is only to be connected to Class II equipment bearing the symbol. 



Made in China

NO. 204E

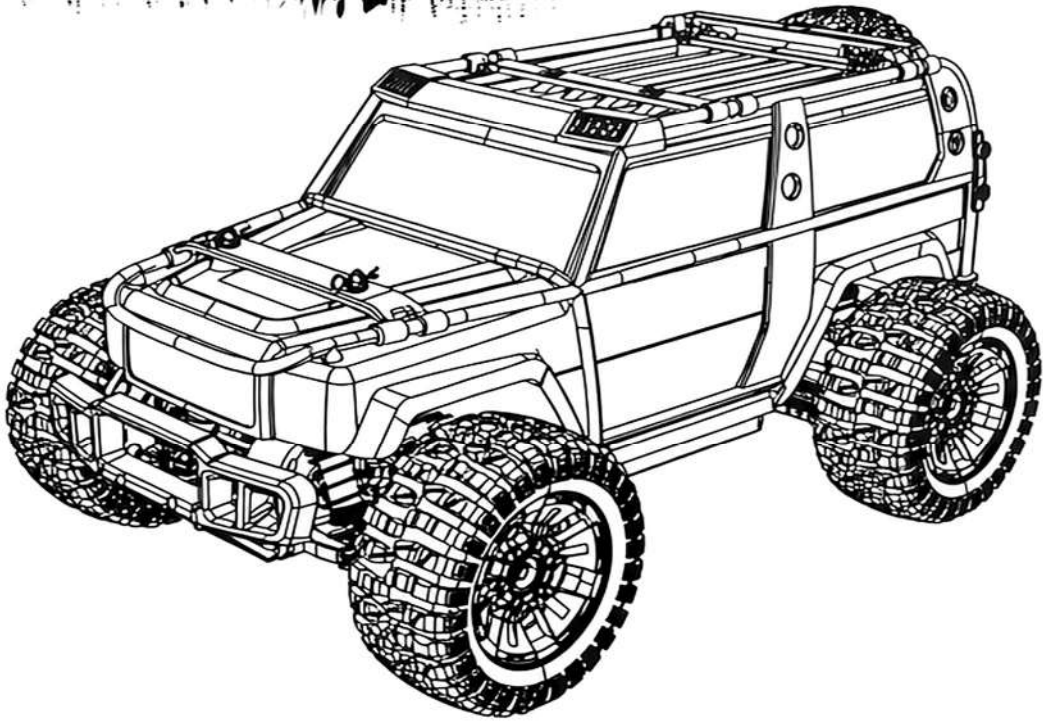

NO. 201E

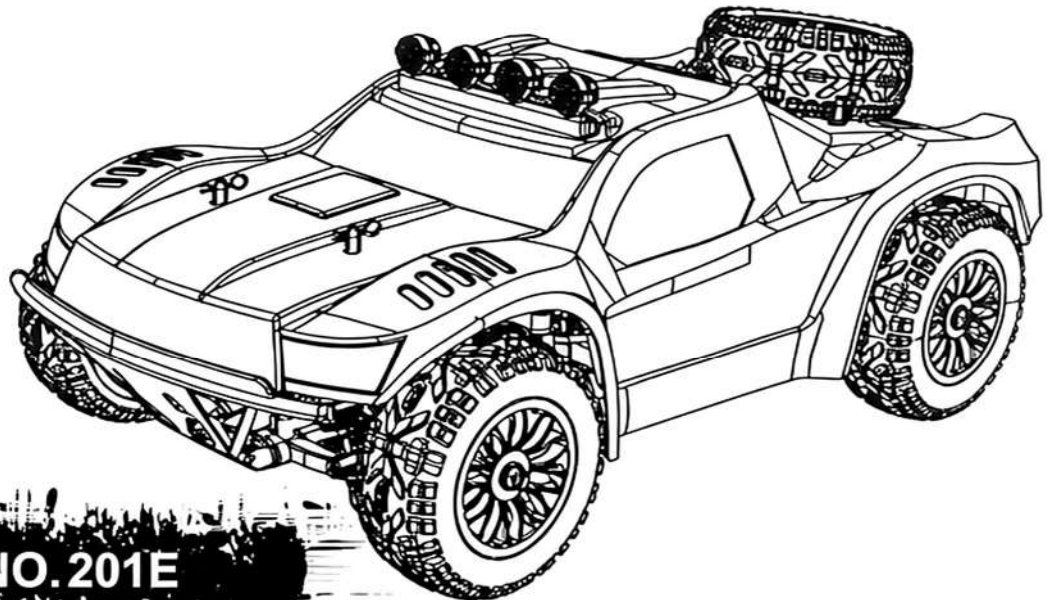

LOOKING FORWARD TO MORE NEW PRODUCTS